



# Central Office Building Purchase

Matawan-Aberdeen Regional School  
District  
July 26, 2021



# Overview

- Funding Source
- Building Location
- Floorplan
- Preschool Expansion
- Cambridge Park
- Timeline





# What is a Capital Reserve Fund?

- A capital reserve fund allows the district to set aside money for future construction projects and major purchases, much like a savings account. The fund cannot be established without voter approval AND reserve funds cannot be spent without voter approval.
- The Government Finance Officers Association recommends that governmental bodies maintain an unreserved fund balance of 5 to 15 percent of the general fund. However, state rules prohibit school districts from keeping more than 4 percent of a district's budget in an undesignated reserve account. Capital reserve funds are exempt from that limitation, allowing schools to save for major expenses, both planned and unplanned.

# NO Tax Impact on Purchase and Renovations

## Capital Reserve Funds:

$$\begin{aligned} & \$1,200,000 \text{ Purchase} \\ + & \text{ \$1,558,000 Estimated Renovation } \\ = & \text{ \$2,758,000 Total Estimated Cost} \end{aligned}$$



Where is the building located?



1027 NJ-  
34,  
Aberdeen

# What will the renovation include?

- Interior Renovations:
  - 10 - Offices
  - 1 - Conference Room
  - 13 - Cubicles
  - Kitchen
  - Bathrooms
  - HVAC upgrades
  - Electrical Systems
  - New Floorplan
  - Etc...

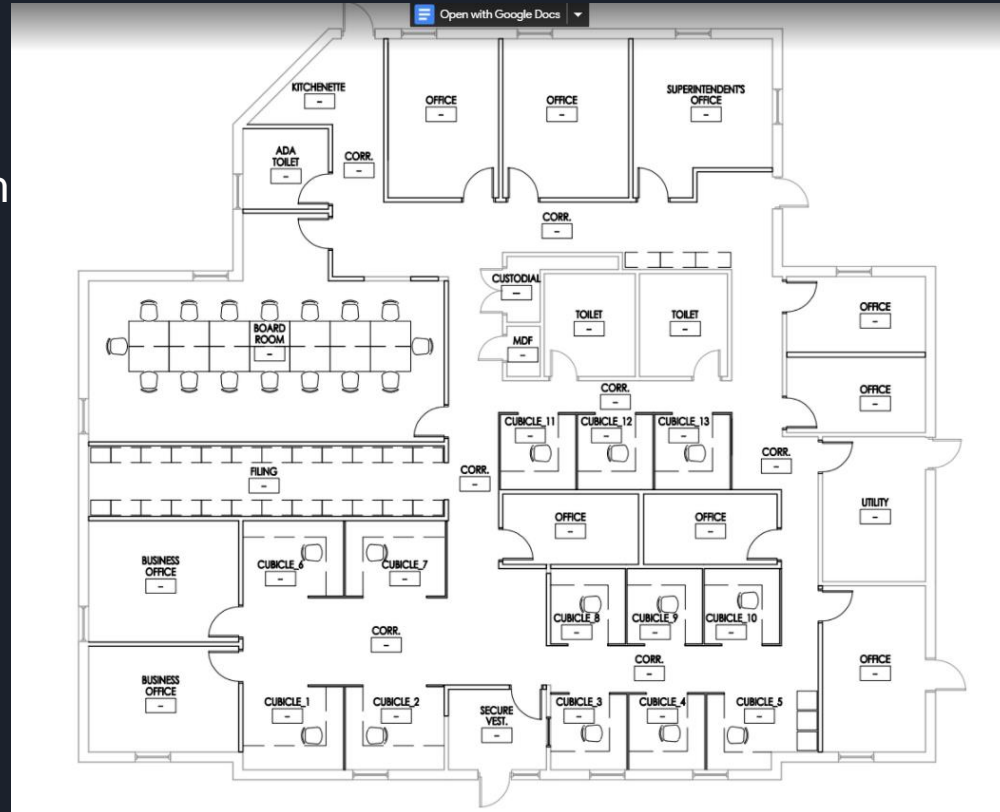

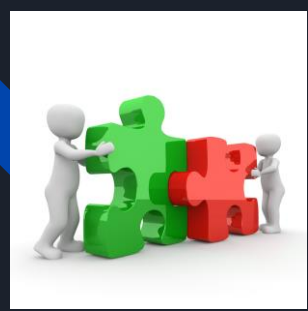

# Preschool Expansion Aid

	<u>School Year</u>	<u>Total Projected Enrollment</u>	<u>Total Yearly Increase</u>	<u>State Funding</u>
Year 1	Feb 2021 - June 2021	148		\$1,574,034
Year 2	2021-2022	220	72	\$2,385,456
Year 3	2022-2023	333	113	TBD
Year 4	2023-2024	393	60	TBD
Year 5	2024-2025	449+	57	TBD

# Cambridge Park - Preschool

## Renovations:

- Convert offices  
7-8 offices to  
TBD number of  
preschool  
classrooms





# Estimated Timeline

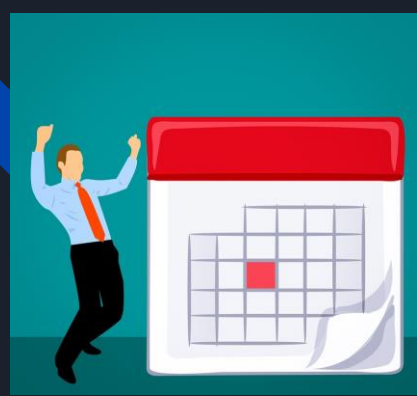

Summer 2021 : Purchase Building

Summer 2021 - Winter 2021 : Renovations to new Central Office

Spring 2022 : Move in to Central Office

Fall 2021 - Winter 2021 : Project Cambridge Park Renovations

Winter 2021 - Summer 2022 : Renovate Cambridge Park offices to classrooms

September 2022 : Cambridge Park opens with increased enrollment for 2022-2023 school year



Questions?